

High-frequency characteristics measurement system

Micro Prober MP Series



MP502

Fully automated high-frequency characteristics measurement system

Optimal equipment for inspecting 5G generation high-speed transmission PCBs, featuring double-sided probing technology.

High repeatability and reproducibility

High-repeatability probing accuracy reduces variation in measurement results attributable to measurers and measurement environments.

High-speed, multi-piece-simultaneous measurement

Enables measurement of characteristic impedance and S-Parameters, with accurate evaluation and analysis of transmission traces.

Can be combined with multi-port type network analyzers from major vendors.

Rohde & Schwarz product



Keysight product



Step and repeat method

High-precision probing for each work piece is realized by repeating image alignment and worksheet movement

4-point clamp and tension method

Clamping the PCB in 4 corners and applying optimal force in XY directions allows flat reforming of thin PCBs

Double-sided probing system

Accurate measurement of double-sided PCBs using independent upper and lower test heads that align the front and back surfaces of the PCB.

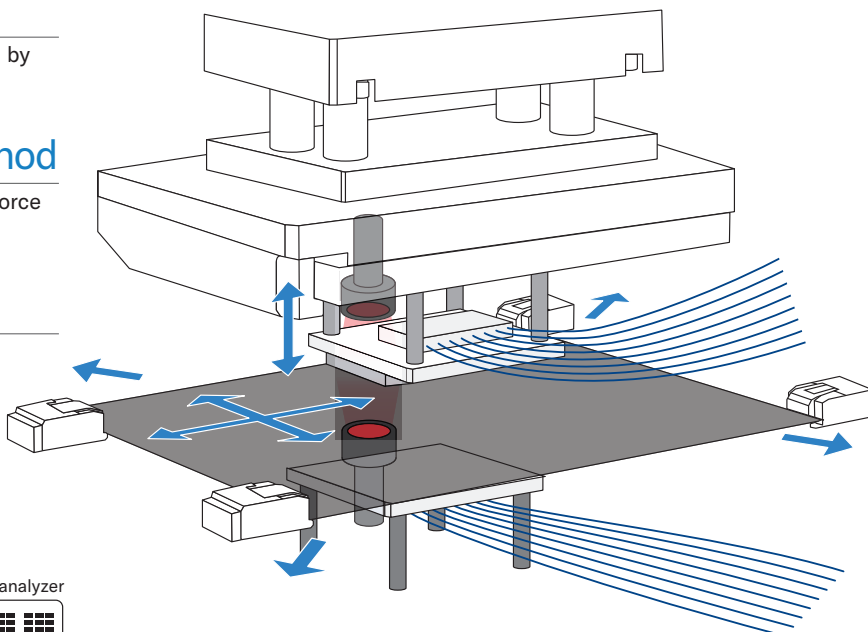

Equipment configuration

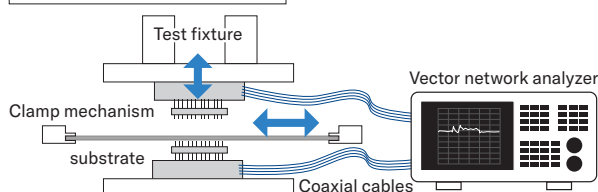

Autoloader*

Fully automated substrate loading and unloading contributes to manpower reductions and uniform quality

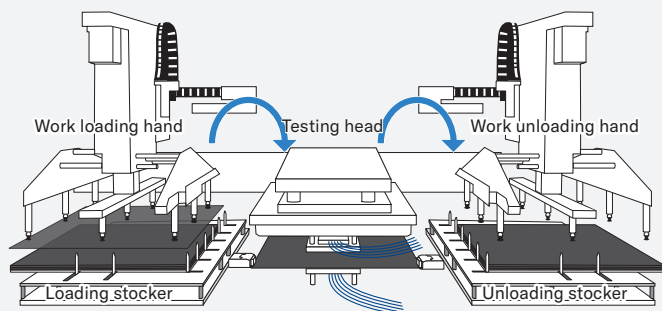

*option

Defect marker

Prints defect marks automatically on defective pieces, preventing manual errors in marking defects

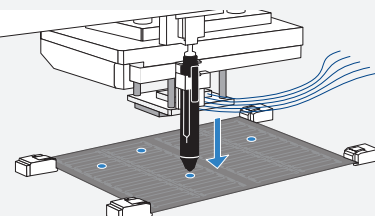

2D-code reader

Links measurement results with data codes for pieces, enabling tracking at piece level even after shipping

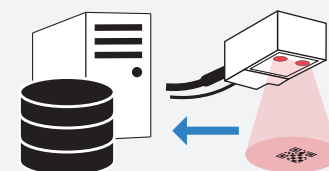

| | | |
|------------------------|--|--|
| Series | Micro Prober | |
| Model | MP502 | MP502-A |
| Applications | Rigid PCBs, Flexible PCBs, Rigid-flex PCBs etc., with high speed transmission circuits | |
| Worksheet size | W150 to 510 mm, D150 to 610 mm | |
| Max. fixture size | W200 mm x D200 mm | |
| Positioning accuracy*1 | ±20μm | |
| Worksheet transfer | Loading: Manual Unloading: Manual | Loading: Automatic Unloading: Automatic |
| External dimensions | W1,700(+650) × H1,600 × D2,170 | W1,880(+650) × H1,785 × D2,545 |
| Weight | Approx. 2,500 kg | Approx. 3,000 kg |
| Measurement items *2 | Insertion losses, reflection losses, VSWR, isolation, TDR etc. | |

MP502

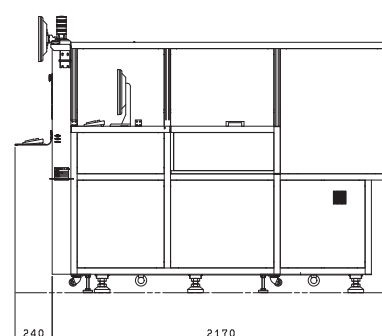
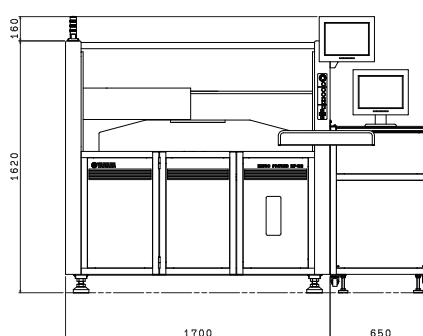

*1 Indicates repeatability of relative positioning of in-house performance tests.

*2 Measurable items and measurement performance of each item differ depending on the specifications/performance of the network analyzer.



YAMAHA FINE TECHNOLOGIES CO., LTD.
FA Division

283 Aoya-cho, Minami-ku, Hamamatsu 435-8568, Japan
TEL 053(467)3601 FAX 053(467)3613
<https://www.yamahafinotech.co.jp/en/>



website



Inquiry

The contents of this catalog are subject to change without notice.